

HKTS30SAT-2

Two Satellite Speakers

User Guide
English



harman/kardon®
Designed to Entertain.™

Harman Kardon® HKTS30SAT-2

Introduction

Thank you for purchasing the Harman Kardon® HKTS30SAT-2 speaker pair, with which you're about to begin many years of listening enjoyment. While state-of-the-art speaker components are hard at work within the HKTS30SAT-2, hookup is simple. Color-coded cables make the HKTS30SAT-2 easy to use.

To obtain maximum enjoyment from your new speaker system, we urge you to take a few minutes to read through this manual. It will help ensure that the connections you make to your receiver or amplifier are correct.

If you have any questions about this product, its installation or its operation, please contact your dealer, the best local source of information.

Description and Features

The HKTS30SAT-2 is a pair of SAT- satellite speakers, each of which features:

- Dual 3" (75mm) video-shielded midrange drivers
- One 3/4" (19mm) video-shielded dome tweeter
- A sealed enclosure
- A built-in, removable base
- A wall-mount bracket
- Color-coded connecting cables

The speaker cables all use a color-coding system to conform to the Consumer Electronics Association (CEA) standard. This color-coding system minimizes confusion when connecting the speakers, especially when you are connecting them to a Harman Kardon receiver.

Optional HTFS 3/E floor stands are available separately from your Harman Kardon dealer.

Included

Two SAT-TS30 satellite speakers

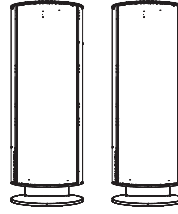

Two wall-mount brackets

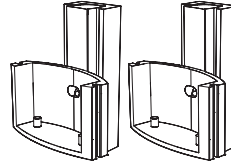

Two metal stop plates and screws

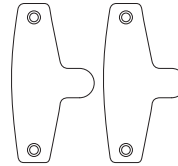

Two 10-meter (32.8-foot) speaker cable
(brown and tan color bands)

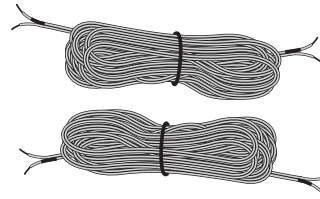

Speaker Placement

Expanding a 5.1-Channel System to a 7.1-Channel System

The surround back speakers should be placed against the rear wall directly behind the listeners, 3–6 feet (0.9m–1.8m) apart, 5–6 feet (1.5m–1.8m) off the floor.

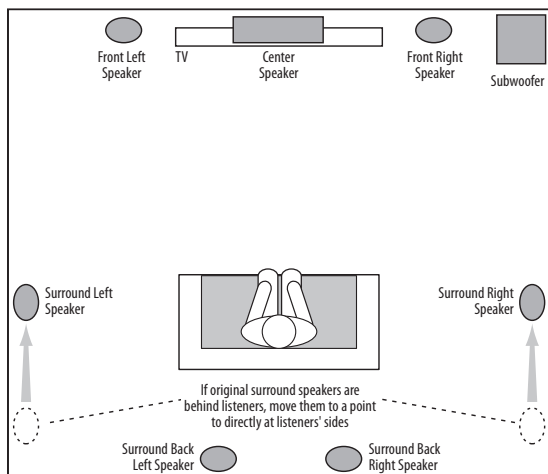
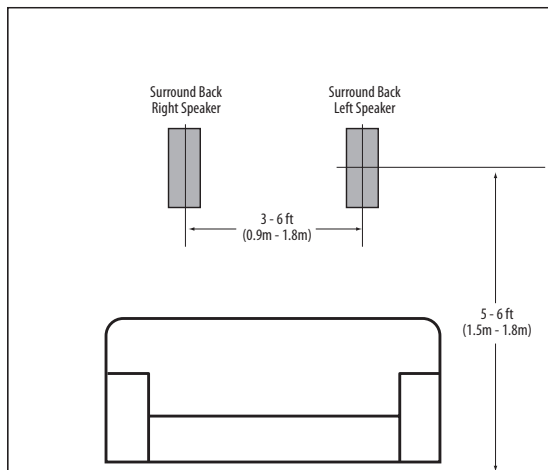

NOTE: If your original surround speakers are located behind the listeners, you should move them up so they are directly to the listeners' sides.

If You're Adding to an Existing HKTS 30 Speaker System:

Your HKTS30SAT-2 speakers are designed to expand an existing HKTS30 speaker system from 5.1 channels to 7.1 channels. You can connect the HKTS30SAT-2 speakers to your receiver's or amplifier's surround back left and surround back right outputs.

If You're Adding to an Existing HKTS 20 Speaker System:

Your HKTS30SAT-2 speakers are designed to expand an existing HKTS20 speaker system from 5.1 channels to 7.1 channels by replacing the existing front left and front right speakers. You can then connect your existing HKTS20 front left and front right speakers to your receiver's or amplifier's surround back left and surround back right outputs.

Mounting Options for HKTS30SAT-2 Speakers

Shelf Placement

You can place the HKTS30SAT-2 speakers on shelves. The satellite speakers have built-in bases for shelf placement. You can also remove the bases if desired.

To remove a speaker's base, pull it straight off the speaker, as shown in the illustration. Applying even pressure to both sides of the base will allow it to slide off smoothly.

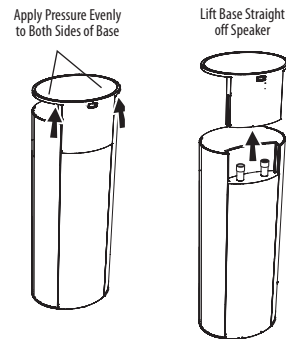

Wall-Mounting

IMPORTANT: Read the *Speaker Connections* section, on page 5, before wall-mounting the HKTS30SAT-2 speakers. You will need to insert the speaker wires through the wall mounts and connect the wires to the speakers during the process of installing the wall-mounts.

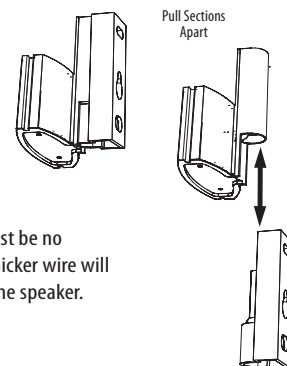

NOTE: If you are using your own speaker wire, it must be no thicker than the wire supplied with the speakers. Thicker wire will prevent the wall-mount bracket from sliding onto the speaker.

1. Decide on the location for the speaker (see *Speaker Placement*, opposite).
2. Remove the speaker's base as explained in *Shelf Placement*, above.
3. Disassemble the wall-mount bracket by sliding the two sections apart, as shown in the illustration.
4. Attach the wall portion of the wall-mount onto the wall using hardware that is appropriate for the wall's construction and materials. We recommend first anchoring the mount using its keyhole, then attaching it with another anchor through its top opening, as shown in the illustration. Note that the HKTS30SAT-2 speakers weigh 3.3 lb (1.5kg). Be sure to use hardware that can support this weight.

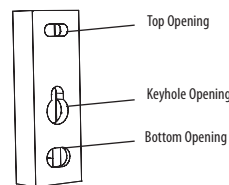

NOTE: If you're running the speaker wire through the wall you can bring it out directly behind the bracket location and insert it through the bottom opening in the wall portion of the wall-mount, as shown in the illustration. This will keep the wire completely hidden from view once the installation is complete.

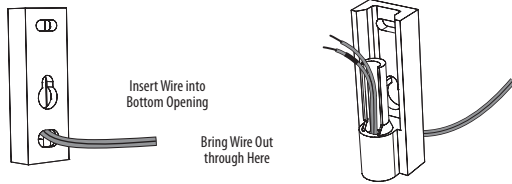

5. If you're not running the speaker wire through the wall, insert it through the wall portion of the wall-mount bracket as shown in the illustration.

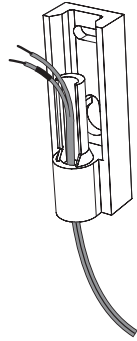

6. Pass the speaker wire through the speaker portion of the wall-mount as shown in the illustration.

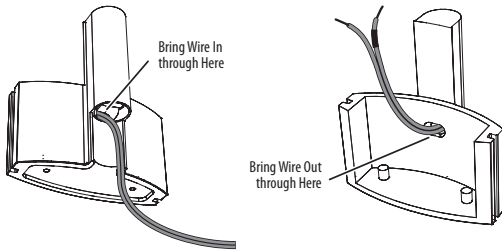

7. If you have not already removed the speaker's base, do so by pulling it straight off the speaker, as shown in the illustration. Applying even pressure to both sides of the base will allow it to slide off smoothly.

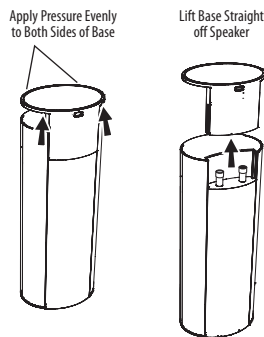

CAUTION: Before making speaker connections, be sure that your receiver or amplifier is turned OFF and preferably, its AC cord is unplugged from the AC outlet.

8. Connect the speaker wire to the speaker terminals as shown in the illustration:

- Press down on the top of the terminal to open the connection hole.
- Insert the wire's bare end all the way into the hole.
- Release the terminal to secure the wire.

Insert the conductor with the colored band into the speaker's red (+) terminal, and insert the other conductor into the speaker's black (-) terminal.

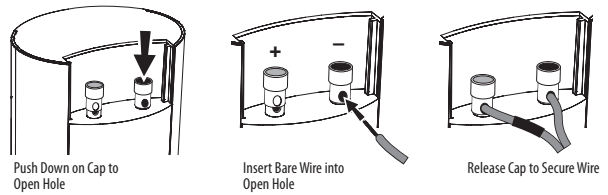

IMPORTANT: Make sure the (+) and (-) bare wires do not touch each other or the other terminal. Touching wires can cause a short circuit that can damage your receiver or amplifier.

9. Slide the speaker portion of wall-mount onto the speaker as shown in the illustration. Fit the wall-mount bracket's grooves onto the rails in the speaker, and apply even pressure on both sides of the mount so it slides straight onto the speaker.

- Push the mount all the way onto the speaker until it snaps into place.
- Pull any slack speaker wire back through the mount as you slide the mount onto the speaker.

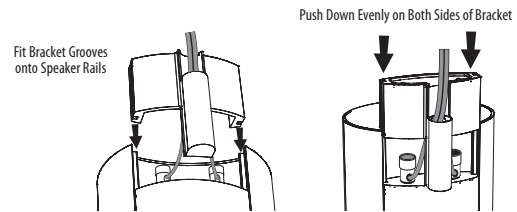

10. Slide the speaker onto the mount's wall section as shown in the illustration. Pull any slack speaker wire back through the mount's wall section.

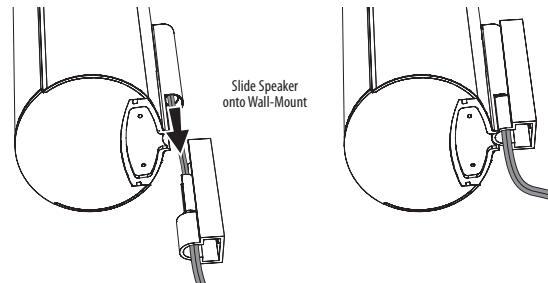

11. Fit the metal stop plate into the recess on the bottom of the wall-mount bracket with the pad facing the bracket, and fasten it to the bracket using two of the supplied screws. Fastening it will prevent the speaker from detaching from the wall-mount bracket and will hold the speaker in position as you rotate it on the wall-mount bracket.

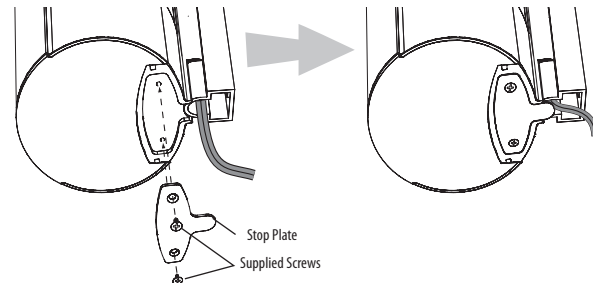

Speaker Connections

CAUTION: Before making speaker connections, be sure that your receiver or amplifier is turned OFF and preferably, its AC cord is unplugged from the AC power outlet.

Color-Coding System

The HKTS30SAT-2 use the channel color-coding system established by the CEA to make setting up your home theater speaker system as easy as possible. The HKTS30SAT-2 systems include speaker wires with color bands on each end.

Speaker Position	Wire Color Band
Surround Back Left	Brown
Surround Back Right	Tan

Speakers and receivers/amplifiers have corresponding (+) and (-) connection terminals. Most electronics manufacturers, including Harman Kardon, use *red* to denote the (+) terminal and *black* for the (-) terminal. Newer Harman Kardon receivers conform to the CEA standard and therefore use a color other than red to denote the (+) terminal for some speaker positions.

Each speaker wire included with your system has colored bands at both ends of the (+) conductor. In addition to the colored bands at each end, each speaker wire's (+) terminal has ribs molded into its insulation to help identify it, while the (-) terminal has no ribs.

It is very important to connect each speaker identically: (+) on the speaker to (+) on the receiver or amplifier, and (-) on the speaker to (-) on the receiver or amplifier. Miswiring one or more speakers results in thin sound, weak bass and a poor stereo image. With the advent of multichannel surround-sound systems, connecting all of the speakers in your system correctly is very important for achieving the proper ambience and directionality of the sound coming from the speakers.

To connect the speaker wire to the terminals on the speakers, press down on the top of the terminal to open the connection hole, insert the wire's bare end all the way into the hole and release the terminal to secure the wire. Insert the conductor with the colored band into the speaker's *red* (+) terminal, and insert the other conductor into the speaker's *black* (-) terminal, as shown in the illustration.

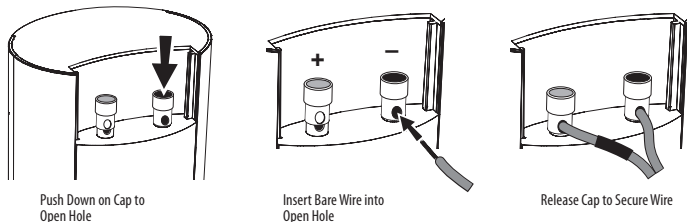

IMPORTANT: Make sure the (+) and (-) bare wires do not touch each other or the other terminal. Touching wires can cause a short circuit that can damage your receiver or amplifier.

Connecting HKTS30SAT-2 Speakers with Supplied Wall-Mount Brackets

Follow the instructions in *Wall-Mounting*, on page 3.

Connecting HKTS30SAT-2 Speakers with Supplied Bases

1. Remove the speaker's base (see *Shelf Placement*, on page 3).
2. Pass the speaker wire through the opening in the speaker base.
3. Connect the speaker wire as described in Color-Coding System, opposite.
4. Reattach the speaker's base as shown in the illustration.

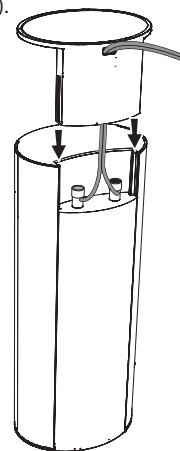

Receiver

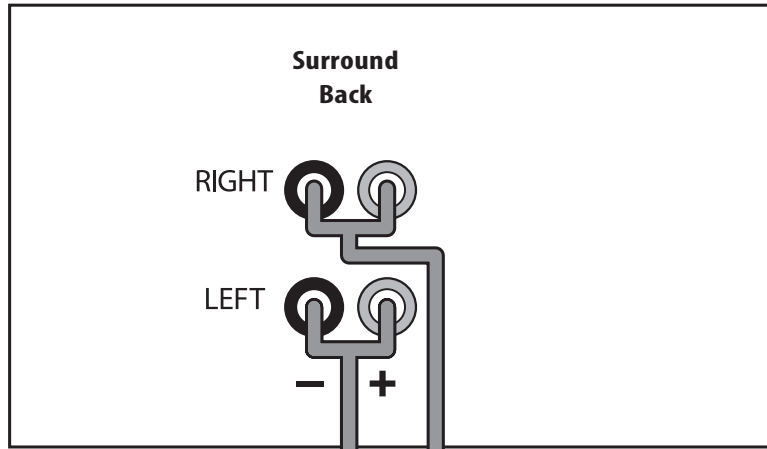

**Surround Back Left
Speaker Cable
(Brown Bands)**

**Surround Back Right
Speaker Cable
(Tan Bands)**

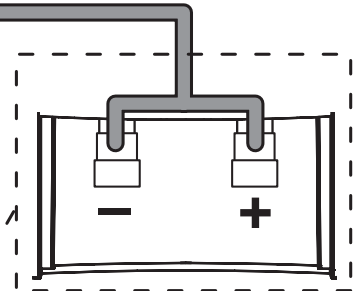
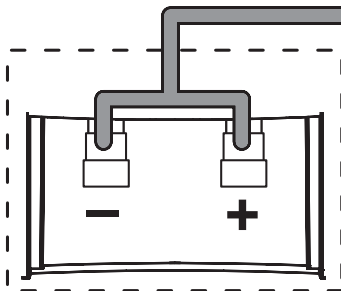

**Surround Back
Left**



**Surround Back
Right**

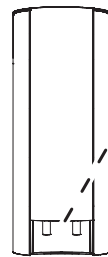

Troubleshooting

If there is no sound from *any* of the speakers:

- Check that the receiver/amplifier is on and a source is playing.
- Make sure that all wires and connections between the receiver/amplifier and the speakers are connected properly.
- Make sure none of the speaker wires is frayed, cut or punctured.
- Review the proper operation of your receiver/amplifier.

If there is no sound coming from *one* speaker:

- Check that the balance control on your receiver/amplifier is not set all the way to one channel.
- Check your receiver/amplifier's speaker setup procedure to make sure that the speaker in question has been enabled and its volume level has not been turned all the way down.
- Make sure that all wires and connections between the receiver/amplifier and the speaker are connected properly.
- Make sure the speaker wires are not frayed, cut or punctured.

If there is no sound coming from the *surround* speakers:

- Check your receiver/amplifier's speaker setup procedure to make sure that the surround speakers have been enabled and their volume levels have not been turned all the way down.
- Make sure that all wires and connections between the receiver/amplifier and the surround speakers are connected properly.
- Make sure the speaker wires are not frayed, cut or punctured.
- Review proper operation of your receiver/processor and its surroundsound features.
- Make sure the movie or TV show you're watching has been recorded in a surround-sound mode. If it is not, check to see if your receiver/amplifier has a different surround-sound mode that you can use.
- Review the operation of your DVD player and the DVD jacket to make sure the DVD features the desired Dolby Digital or DTS® surround-sound mode, and that you have properly selected that mode using both the DVD player's menu and the disc's menu.

If the system plays at low volumes but shuts off as volume is increased:

- Make sure that all wires and connections between the receiver/amplifier and the speakers are connected properly.
- Make sure none of the speaker wires is frayed, cut or punctured.
- If you're using more than one pair of main speakers, check to be sure that you're not operating the system below the receiver/amplifier's minimum impedance requirements.

Specifications

SAT-TS30 Satellites

Recommended Power

10 ~ 120 watts

Impedance

8 ohms nominal

Sensitivity

86dB @ 2.83V/1 meter

Tweeter

One 3/4" (19mm) dome, video-shielded

Midrange

Dual 3" (75mm) drivers, video-shielded

Dimensions – including stands (H x W x D)

11-25/32" x 4-11/32" x 3-15/32"

(299mm x 110mm x 88mm)

Weight

3.3 lb (1.5kg)

© 2010 Harman International Industries, Incorporated. All rights reserved.

Features, specifications and appearance are subject to change without notice.

Harman Kardon is a trademark of Harman International Industries, Incorporated, registered in the United States and/or other countries. Designed to Entertain is a trademark of Harman International Industries, Incorporated.

CEA is a registered trademark of the Consumer Electronics Association.

Dolby and Pro Logic are registered trademarks of Dolby Laboratories.

DTS is a registered trademark of Digital Theater Systems, Inc.

Harman International

Harman Consumer Group, Inc.
8500 Balboa Boulevard, Northridge, CA 91329 USA
516.255.4545 (USA only)

www.harmankardon.com

Made in P.R.C.

Part No. 950-0289-001